

SL8330 WARDROBE LED LIGHTING PROFILE

Superlight SL8330 Wardrobe LED mounting profile is a unique task lighting solution which is both stylish and functional. The profile can incorporate many available Superlight LED Superstrip, VRX LED, CRX COB LED LED Turbostrip, or LED Nanostrip LED products for a fully functional illuminated hanging clothes rail system.

SPECIFICATIONS

Standard Profile Length:	2mtr
Custom Lengths Available:	Yes
Profile Diameter:	24mm OD
Standard Finish:	Anodised Silver
Custom Colours/Finishes:	Dulux Powdercoat
Compatible LED Product:	LED Superstrip, VRX LED, CRX LED
Lens:	Opal Acrylic Lens Insert

PHOTOMETRIC INFORMATION

Photometric performance is dependant on LED configuration.

TYPICAL APPLICATIONS

High end residential projects - wardrobe lighting solution, Clothing fashion retail displays. Hotels and apartments, walk-in robe lighting, wardrobe and joinery lighting

CONTROL & DIMMING COMPATIBILITY

This product is available in dimmable configurations including Phase Dim, DALI, 1-10V, DMX512. Please contact us for options and availability.

ORDERING INFORMATION

SL8330-00	Superlight 24mm Round Wardrobe LED Mounting Profile
SL8330-12	Opal Polycarbonate Lens Diffuser to suit SL8330
SL8330-55	Moulded Polycarbonate Wall Bracket to suit SL8330
SL8330-ENDCAPS	End Cap Kit (set of 2pcs)
SL8330-TCLIP	Support Bracket T-Clip to suit SL8330
SL8330-SCLIP	Support Bracket S-Clip to suit SL8330

CUSTOMISATION OPTIONS

Supplied in custom lengths as required
Various LED configuration options
Mounting profile can be powdercoated by request
Dimmable single colour or white-mix CCT control options
Mounting hardware and accessories available separately

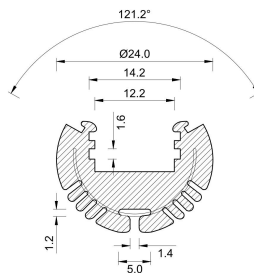

ACCESSORIES (OPTIONAL)



End Caps (kit 2pcs)



Wall Bracket Kit



S-Clip Wall Support



T-Clip Support Bracket

Please be aware that the loading capacity of the Superlight SL8330 wardrobe rail can be compromised by overloading with hanging clothing articles, potentially resulting in unwanted flex. To ensure optimal rigidity and stability, it is advisable to assess the total weight of the intended load and consider the installation of mechanical support accessories, such as T-Clip and S-Clip support brackets (sold separately), if necessary.

All product specifications are subject to change without notice. Superlight accepts no liabilities as a result of errors, updates or omissions. Please re-confirm all product details prior to ordering.

